

IRRIGATION NOTES:

1. ALL WORK SHALL BE DONE IN CONFORMANCE WITH THE CURRENT VERSION OF THE CITY OF DURANGO, COLORADO IRRIGATION AND LANDSCAPE STANDARDS. INSTALL ALL EQUIPMENT AS SHOWN ON THE PLANS AND DETAILS, AND AS STATED IN THE SPECIFICATIONS.
2. THE CONTRACTOR SHALL MAINTAIN AN ACCURATE AS-BUILT RECORD OF CHANGES TO THE IRRIGATION SYSTEM, INCLUDING MEASUREMENTS TO IRRIGATION SLEEVE LOCATIONS, TO BE DELIVERED TO THE OWNER UPON COMPLETION OF THE WORK. ELECTRONIC COPIES OF THE AS-BUILT PLANS SHALL BE PROVIDED IN BOTH AUTOCAD AND PDF FORMAT.
3. THE SYSTEM DESIGN IS BASED ON THE MINIMUM OPERATING PRESSURE SHOWN AT EACH POINT OF CONNECTION (P.O.C.). THE IRRIGATION CONTRACTOR SHALL VERIFY ALL PRESSURES ON SITE PRIOR TO COMMENCING WITH THE INSTALLATION OF THE IRRIGATION SYSTEM.
4. THIS DESIGN IS DIAGRAMMATIC - ANY EQUIPMENT OR IRRIGATION LINES SHOWN IN PAVED AREAS OR OUTSIDE OF ROAD R.O.W. IS FOR DESIGN CLARIFICATION ONLY AND SHALL BE INSTALLED WITHIN PLANTED AREAS WHEREVER POSSIBLE.
5. THE CONTRACTOR SHALL ESTABLISH LOCATIONS FOR ALL SPRINKLERS, IRRIGATION LINES, AND EQUIPMENT TO FIT FIELD CONDITIONS AND THE LOCATIONS OF LINES AND HEADS SHALL BE APPROVED BY THE OWNER'S REPRESENTATIVE PRIOR TO THE START OF TRENCHING. NO TRENCHING SHALL BE DONE UNTIL THE FIELD STAKING IS APPROVED BY THE OWNER'S REPRESENTATIVE. THE CONTRACTOR SHALL MAINTAIN AND PROTECT THE APPROVED STAKING LAYOUT.
6. MAIN LINES SHALL BE BURIED MIN. 24" DEEP AND LATERAL LINES SHALL BE MIN. 18" DEEP - SEE SPECS. SOLVENT WELD SADDLE CLAMPS AND MALE ADAPTERS WILL NOT BE ACCEPTED.
7. MIN. 4" DIA. CLASS 200 PVC SLEEVES SHALL BE INSTALLED FOR ALL IRRIGATION PIPE AND WIRING UNDER PAVEMENT. SEPARATE SLEEVES SHALL BE INSTALLED FOR PIPING AND WIRING. EXTEND SLEEVES 12" PAST EDGE OF PAVEMENT AND MARK FOR FUTURE LOCATING.
8. MANUAL DRAIN VALVES SHALL BE INSTALLED AS SHOWN ON THE PLANS AND ALSO AT ALL LOW POINTS OF THE MAIN LINE PIPE. THE IRRIGATION CONTRACTOR SHALL ALSO BE RESPONSIBLE FOR INSTALLING CHECK VALVES AS REQUIRED BY FIELD CONDITIONS TO PREVENT DAMAGE AND EROSION DUE TO EXCESSIVE LOW HEAD RUNOFF.
9. VALVES AND APPERTUNANCES (I.E., ISOLATION VALVES, QUICK COUPLING VALVES, CHECK VALVES, ETC.) SHALL BE ACCESSIBLE IN MIN. 10" DIA. VALVE BOXES WITH GREEN LOCKING LIDS. IRRIGATION ZONE VALVES SHALL BE INSTALLED IN RECTANULAR VALVE BOXES WITH GREEN LOCKING LIDS UNLESS SPECIFIED OTHERWISE. ALL VALVE BOX LIDS SHALL BE STAMPED TO IDENTIFY THE IRRIGATION ZONE OR EQUIPMENT INSTALLED IN THE BOX.
10. WIRES FROM TWO-WIRE DECODER CONTROLLER TO ZONE VALVES SHALL BE RAINBIRD #14-2UF SINGLE STRAND DIRECT BURIAL DOUBLE JACKETED MAXI-CABLE WITH U.L. APPROVED WATERPROOF CONNECTORS. WIRE SPLICES WILL NOT BE PERMITTED UNLESS APPROVED BY THE OWNER'S REPRESENTATIVE, AND THE LOCATION OF THESE SPLICES SHALL BE DOCUMENTED ON THE AS-BUILT RECORD DRAWINGS.
11. INSTALL ALL NECESSARY EQUIPMENT FOR THE TWO-WIRE DECODER SYSTEM, INCLUDING SURGE PROTECTION AT MAX. 500' INTERVALS, AS RECOMMENDED BY THE MANUFACTURER.
12. THE MAINLINES SHALL BE INSPECTED FOR LEAKS AFTER A MINIMUM 150 PSI STATIC PRESSURE HAS BEEN MAINTAINED FOR ONE HOUR IN A HYDROSTATIC TEST OBSERVED BY THE OWNER'S REPRESENTATIVE - SEE SPECIFICATIONS.
13. THE IRRIGATION CONTRACTOR SHALL FLUSH ALL LINES AND ADJUST ALL HEADS FOR MAXIMUM PERFORMANCE AND TO PREVENT OVERSPRAY ONTO WALKS, PAVEMENTS, BUILDINGS, WALLS, FENCES, AND OTHER STRUCTURES AS MUCH AS POSSIBLE. THIS WORK SHALL INCLUDE SELECTING THE BEST RADIUS AND DEGREE OF ARC FOR THE SPRINKLER HEAD NOZZLES TO FIT EXISTING SITE CONDITIONS.

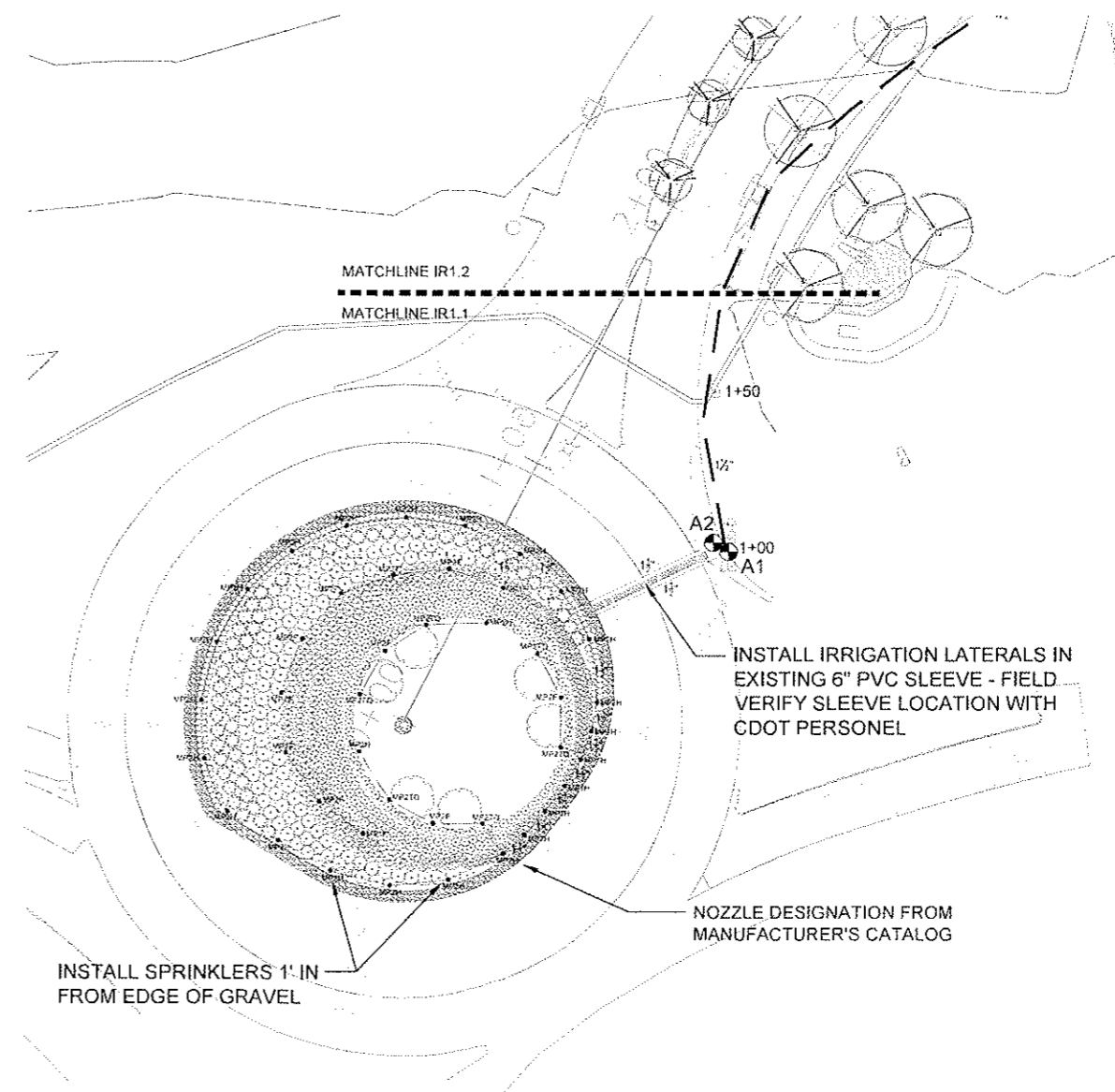

SPRINKLER TYPE BY ZONE			
ZONE	SPRINKLER	VALVE	GPM
A1	RD1812-S-P45-F w/ Hunter MP2000	1"	22
A2	RD1812-S-P45-F w/ Hunter MP2000	1"	21
A3	1402 HCV	1"	23
A4	1401 HCV	1"	23
A5	1402 HCV	1"	17
A6	1402 HCV	1"	17
A7	1402 HCV	1"	11
A8	1402 HCV	1"	11
B1	1402 HCV	1"	20
B2	1402 HCV	1"	20
B3	1402 HCV	1"	14
B4	1401 HCV	1"	10
B5	1402 HCV	1"	11
B6	1402 HCV	1"	13

- KEY:
- RAINBIRD LDI TWO-WIRE DECODER INTERFACE
 - BACKFLOW PREVENTER ENCLOSURE
 - 1 1/2" DIA. SCH. 40 PVC MAINLINE
 - SCH. 40 PVC LATERAL LINE (MIN. 1" DIA.)
 - RAINBIRD MAXI-CABLE
 - RAINBIRD LSP-1 LINE SURGE PROTECTION
 - RAINBIRD PEB ZONE VALVE
 - RAINBIRD 1400 BUBBLER SPRINKLER
 - RAINBIRD RD1812 POP-UP SPRINKLER
 - ISOLATION VALVE (LINE SIZE)
 - RAINBIRD 44RC QUICK COUPLING VALVE
 - 1" AIR/VACUUM VENT
 - MANUAL DRAIN VALVE
 - SWING CHECK VALVE (LINE SIZE)
 - SPRING CHECK VALVE (LINE SIZE)
 - CLASS 200 PVC SLEEVE (MIN. 4" DIA.)
 - EXISTING 6" DIA. SCH. 40 PVC SLEEVE

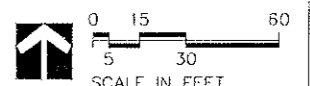

Goff
ENGINEERING & SURVEYING INC.
GOFF ENGINEERING & SURVEYING, INC.
126 ROCK POINT DRIVE SUITE A
P.O. BOX 97
DURANGO,
COLORADO 81302
(970) 247-1705
www.GoffEngineering.com

LI
LANDSCAPE ARCHITECTURE
1209 East 2nd Ave. Room 23
Durango, CO 81302
Goff Engineering & Surveying, Inc. ©

**US 160 / WILSON GULCH
ROADWAY EXTENSION
CITY OF DURANGO, COLORADO
PROJECT STA-M350-022: SA# 19902**

Issue Record:
100% CONSTRUCTION DOCUMENTS
MARCH 31, 2019

Revisions:

Project Number: 11-049
Drawn By: DM
Designed by: DM
Checked By:

IR 1.1
IRRIGATION PLAN
AND NOTES

ORIGINAL

ORIGINAL

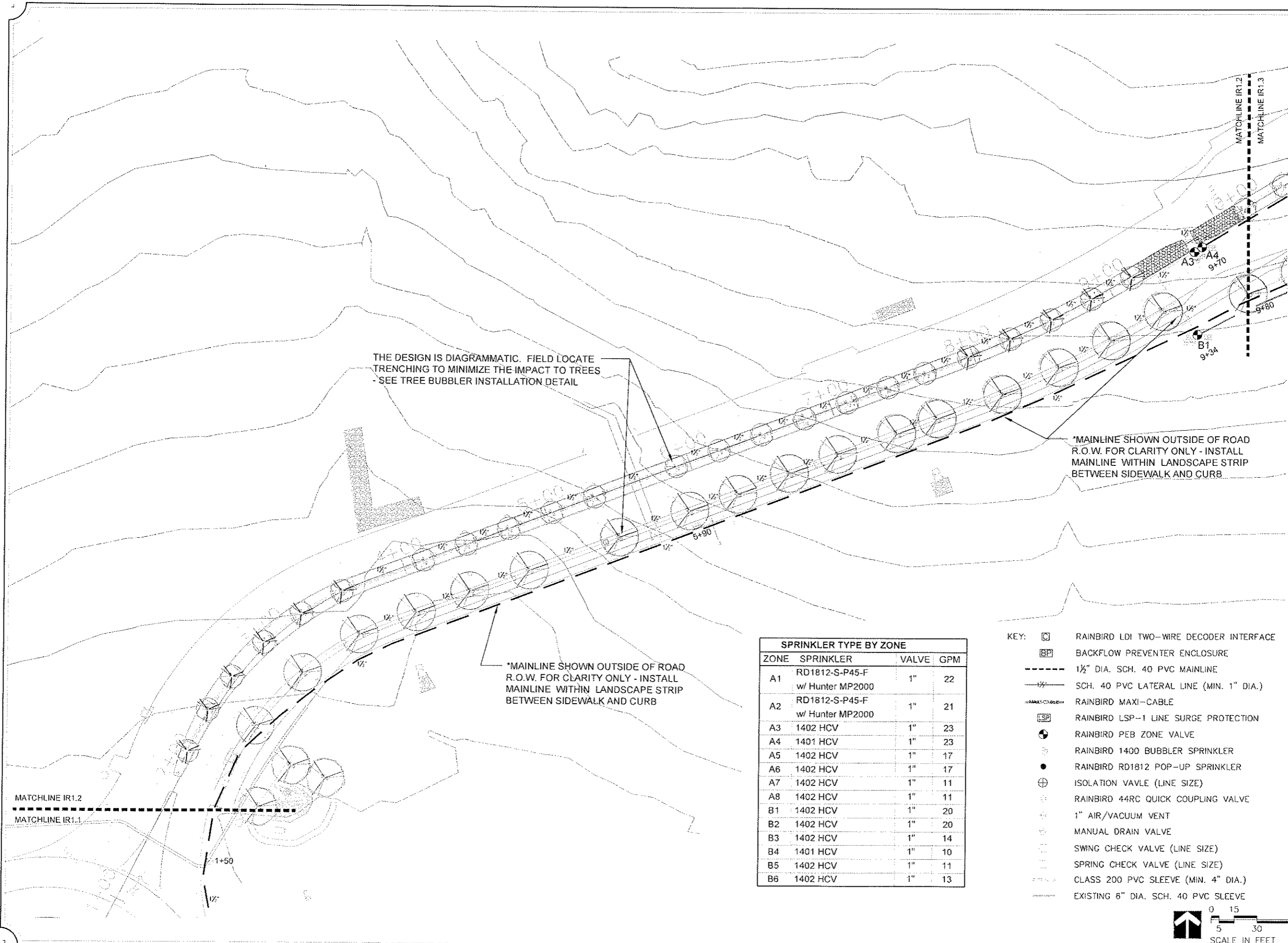

THE DESIGN IS DIAGRAMMATIC. FIELD LOCATE TRENCHING TO MINIMIZE THE IMPACT TO TREES - SEE TREE BUBBLER INSTALLATION DETAIL

*MAINLINE SHOWN OUTSIDE OF ROAD R.O.W. FOR CLARITY ONLY - INSTALL MAINLINE WITHIN LANDSCAPE STRIP BETWEEN SIDEWALK AND CURB

*MAINLINE SHOWN OUTSIDE OF ROAD R.O.W. FOR CLARITY ONLY - INSTALL MAINLINE WITHIN LANDSCAPE STRIP BETWEEN SIDEWALK AND CURB

SPRINKLER TYPE BY ZONE			
ZONE	SPRINKLER	VALVE	GPM
A1	RD1812-S-P45-F w/ Hunter MP2000	1"	22
A2	RD1812-S-P45-F w/ Hunter MP2000	1"	21
A3	1402 HCV	1"	23
A4	1401 HCV	1"	23
A5	1402 HCV	1"	17
A6	1402 HCV	1"	17
A7	1402 HCV	1"	11
A8	1402 HCV	1"	11
B1	1402 HCV	1"	20
B2	1402 HCV	1"	20
B3	1402 HCV	1"	14
B4	1401 HCV	1"	10
B5	1402 HCV	1"	11
B6	1402 HCV	1"	13

- KEY:
- RAINBIRD LDI TWO-WIRE DECODER INTERFACE
 - BACKFLOW PREVENTER ENCLOSURE
 - 1/2" DIA. SCH. 40 PVC MAINLINE
 - SCH. 40 PVC LATERAL LINE (MIN. 1" DIA.)
 - RAINBIRD MAXI-CABLE
 - RAINBIRD LSP-1 LINE SURGE PROTECTION
 - RAINBIRD PEB ZONE VALVE
 - RAINBIRD 1400 BUBBLER SPRINKLER
 - RAINBIRD RD1812 POP-UP SPRINKLER
 - ISOLATION VALVE (LINE SIZE)
 - RAINBIRD 44RC QUICK COUPLING VALVE
 - 1" AIR/VACUUM VENT
 - MANUAL DRAIN VALVE
 - SWING CHECK VALVE (LINE SIZE)
 - SPRING CHECK VALVE (LINE SIZE)
 - CLASS 200 PVC SLEEVE (MIN. 4" DIA.)
 - EXISTING 6" DIA. SCH. 40 PVC SLEEVE

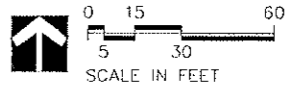

Goff
ENGINEERING & SURVEYING, INC.
Goff Engineering & Surveying, Inc.
126 ROCK POINT DRIVE SUITE A
P.O. BOX 97
DURANGO, COLORADO 81302
(970) 247-1705
www.GoffEngineering.com

LANDSCAPE ARCHITECTURE
LAND PLANNING
GRAPHIC DESIGN
1008 East Durango Ave. Room 33
Durango, CO 81302 • 970.247.1705

Goff Engineering & Surveying, Inc. expressly reserves the common law copyright and other property rights in these plans. These plans are not to be changed or copied in any form or manner whatsoever nor are they to be assigned to any third party without first obtaining written permission and consent of Goff Engineering & Surveying, Inc. ©

US 160 / WILSON GULCH ROADWAY EXTENSION
CITY OF DURANGO, COLORADO
PROJECT STA-M350-022: SA# 19902

Issue Record:
100% CONSTRUCTION DOCUMENTS
MARCH 31, 2015

Revisions:

Project Number: 11-048
Drawn By: DM
Designed by: DM
Checked By:

Sheet
IR 1.2
IRRIGATION PLAN

ORIGINAL

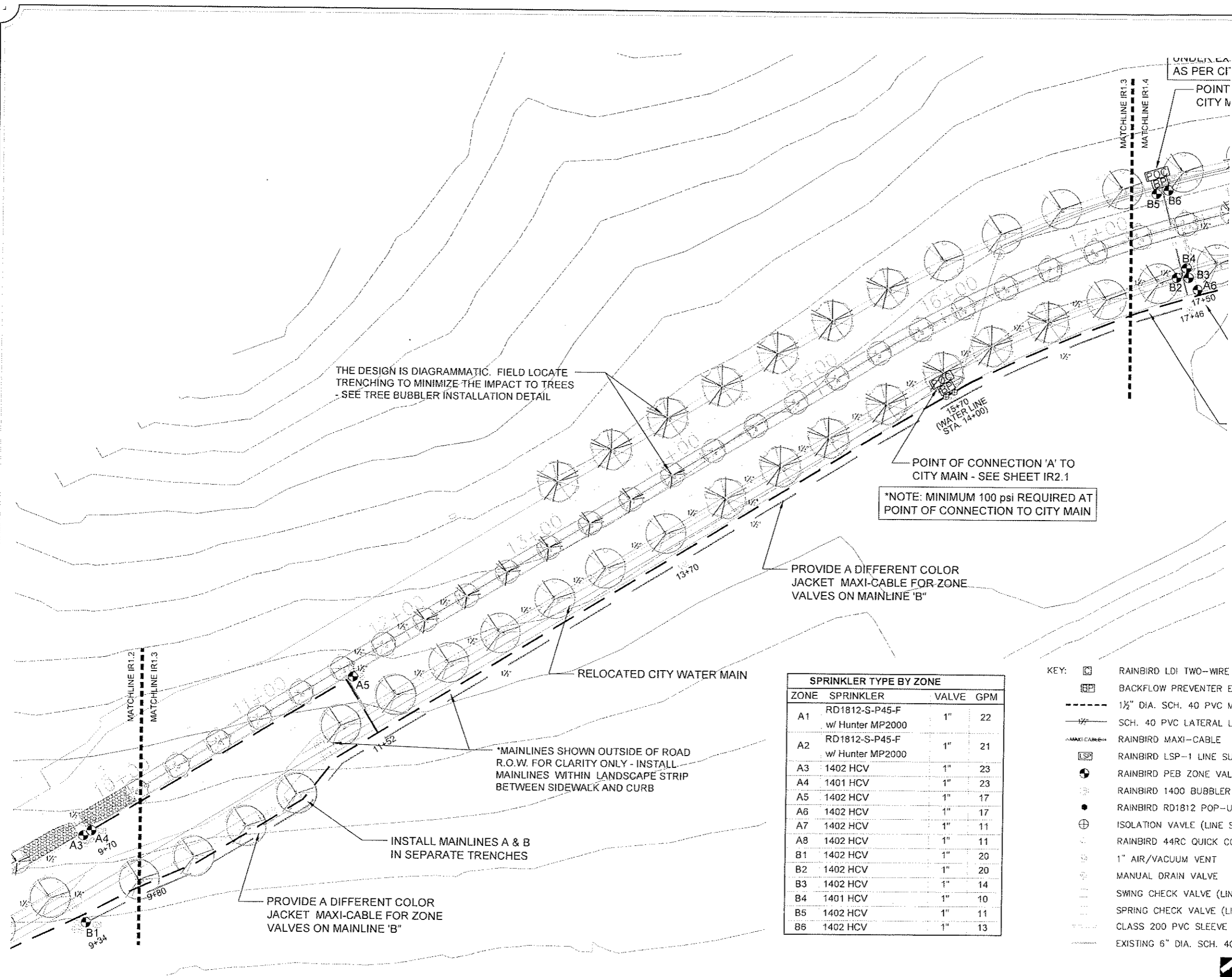

SPRINKLER TYPE BY ZONE			
ZONE	SPRINKLER	VALVE	GPM
A1	RD1812-S-P45-F w/ Hunter MP2000	1"	22
A2	RD1812-S-P45-F w/ Hunter MP2000	1"	21
A3	1402 HCV	1"	23
A4	1401 HCV	1"	23
A5	1402 HCV	1"	17
A6	1402 HCV	1"	17
A7	1402 HCV	1"	11
A8	1402 HCV	1"	11
B1	1402 HCV	1"	20
B2	1402 HCV	1"	20
B3	1402 HCV	1"	14
B4	1401 HCV	1"	10
B5	1402 HCV	1"	11
B6	1402 HCV	1"	13

- KEY:
- RAINBIRD LDI TWO-WIRE DECODER INTERFACE
 - BACKFLOW PREVENTER ENCLOSURE
 - 1 1/2" DIA. SCH. 40 PVC MAINLINE
 - SCH. 40 PVC LATERAL LINE (MIN. 1" DIA.)
 - RAINBIRD MAXI-CABLE
 - RAINBIRD LSP-1 LINE SURGE PROTECTION
 - RAINBIRD PEB ZONE VALVE
 - RAINBIRD 1400 BUBBLER SPRINKLER
 - RAINBIRD RD1812 POP-UP SPRINKLER
 - ISOLATION VALVE (LINE SIZE)
 - RAINBIRD 44RC QUICK COUPLING VALVE
 - 1" AIR/VACUUM VENT
 - MANUAL DRAIN VALVE
 - SWING CHECK VALVE (LINE SIZE)
 - SPRING CHECK VALVE (LINE SIZE)
 - CLASS 200 PVC SLEEVE (MIN. 4" DIA.)
 - EXISTING 6" DIA. SCH. 40 PVC SLEEVE

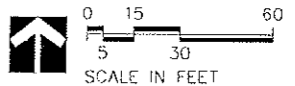

GOFF
ENGINEERING & SURVEYING, INC.

GOFF ENGINEERING & SURVEYING, INC.
126 ROCK POINT DRIVE SUITE A
P.O. BOX 97
DURANGO, COLORADO 81302
(970) 247-1705
www.GoffEngineering.com

DM
LANDSCAPE ARCHITECTURE
Landscape Architecture
126 Rock Point Drive Suite A
Durango, CO 81302

Goff Engineering & Surveying, Inc. expressly reserves the common law copyright and other property rights in these plans. These plans are not to be changed or copied in any form or manner whatsoever nor are they to be assigned to any third party without first obtaining written permission and consent of Goff Engineering & Surveying, Inc. ©

**US 160 / WILSON GULCH
ROADWAY EXTENSION
CITY OF DURANGO, COLORADO
PROJECT STA-M350-022: SA# 19902**

Issue Record:
ISSUE CONSTRUCTION DOCUMENTS
MARCH 31, 2013

Revisions:

Project Number: 11-043

Drawn By: DM

Designed by: DM

Checked By:

Sheet:

IR 1.3
IRRIGATION PLAN



Goff Engineering & Surveying, Inc. expressly reserves the common law copyright and other property rights in these plans. These plans are not to be changed or copied in any form or manner whatsoever nor are they to be assigned to any third party without first obtaining written permission and consent of Goff Engineering & Surveying, Inc. ©

US 160 / WILSON GULCH ROADWAY EXTENSION
CITY OF DURANGO, COLORADO
PROJECT STA-M350-022: SA# 19902

Issue Record:
100% CONSTRUCTION DOCUMENTS
MARCH 31, 2016

Revisions:

Project Number: 11-018
Drawn By: DM
Designed by: DM
Checked By:
Sheet

IR 1.4
IRRIGATION PLAN

ORIGINAL

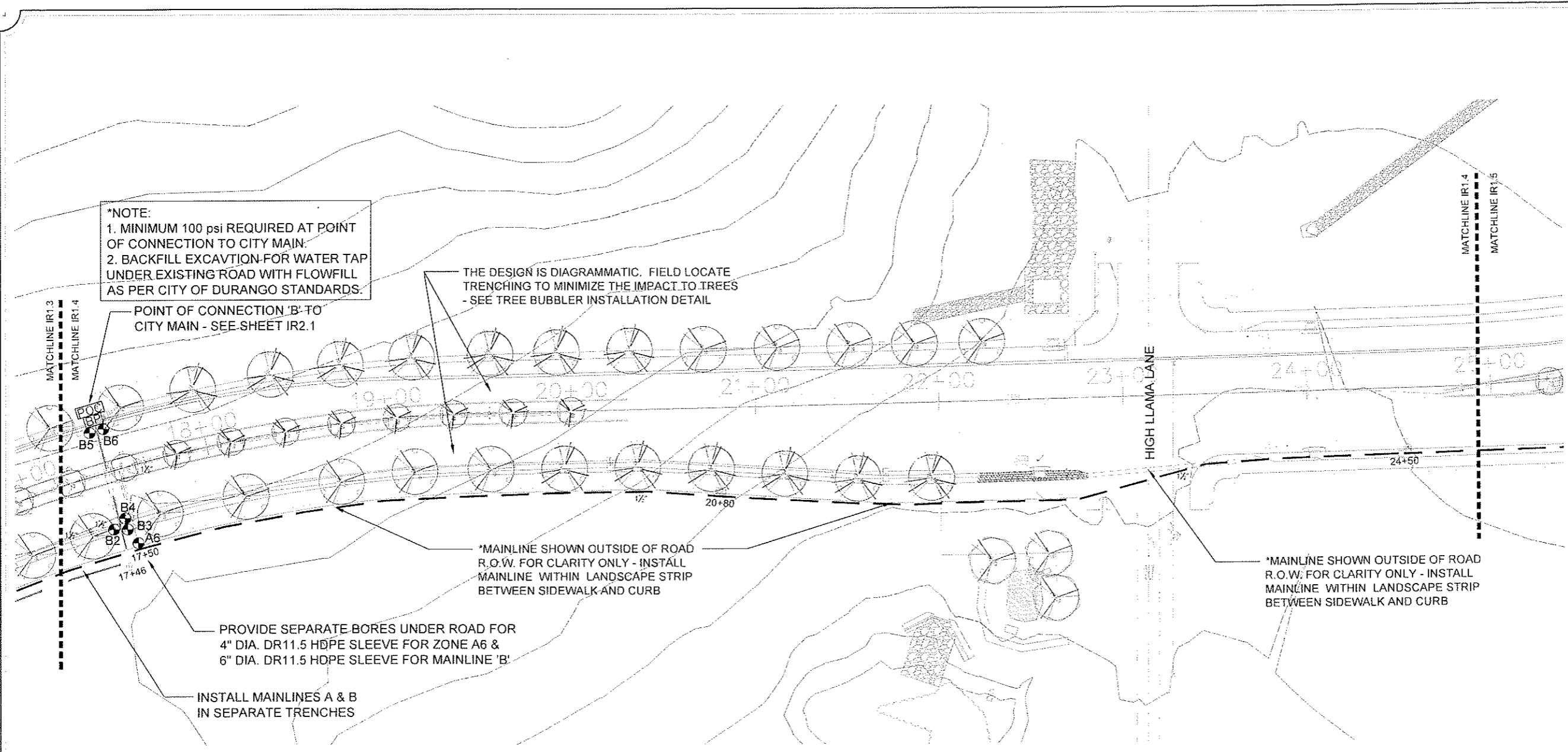

***NOTE:**
1. MINIMUM 100 psi REQUIRED AT POINT OF CONNECTION TO CITY MAIN.
2. BACKFILL EXCAVATION FOR WATER TAP UNDER EXISTING ROAD WITH FLOWFILL AS PER CITY OF DURANGO STANDARDS.

POINT OF CONNECTION 'B' TO CITY MAIN - SEE SHEET IR2.1

THE DESIGN IS DIAGRAMMATIC. FIELD LOCATE TRENCHING TO MINIMIZE THE IMPACT TO TREES - SEE TREE BUBBLER INSTALLATION DETAIL

*MAINLINE SHOWN OUTSIDE OF ROAD R.O.W. FOR CLARITY ONLY - INSTALL MAINLINE WITHIN LANDSCAPE STRIP BETWEEN SIDEWALK AND CURB

*MAINLINE SHOWN OUTSIDE OF ROAD R.O.W. FOR CLARITY ONLY - INSTALL MAINLINE WITHIN LANDSCAPE STRIP BETWEEN SIDEWALK AND CURB

PROVIDE SEPARATE BORES UNDER ROAD FOR 4" DIA. DR11.5 HDPE SLEEVE FOR ZONE A6 & 6" DIA. DR11.5 HDPE SLEEVE FOR MAINLINE 'B'

INSTALL MAINLINES A & B IN SEPARATE TRENCHES

SPRINKLER TYPE BY ZONE			
ZONE	SPRINKLER	VALVE	GPM
A1	RD1812-S-P45-F w/ Hunter MP2000	1"	22
A2	RD1812-S-P45-F w/ Hunter MP2000	1"	21
A3	1402 HCV	1"	23
A4	1401 HCV	1"	23
A5	1402 HCV	1"	17
A6	1402 HCV	1"	17
A7	1402 HCV	1"	11
A8	1402 HCV	1"	11
B1	1402 HCV	1"	20
B2	1402 HCV	1"	20
B3	1402 HCV	1"	14
B4	1401 HCV	1"	10
B5	1402 HCV	1"	11
B6	1402 HCV	1"	13

- KEY:**
- RAINBIRD LDI TWO-WIRE DECODER INTERFACE
 - BACKFLOW PREVENTER ENCLOSURE
 - 1/2" DIA. SCH. 40 PVC MAINLINE
 - SCH. 40 PVC LATERAL LINE (MIN. 1" DIA.)
 - RAINBIRD MAXI-CABLE
 - RAINBIRD LSP-1 LINE SURGE PROTECTION
 - RAINBIRD PEB ZONE VALVE
 - RAINBIRD 1400 BUBBLER SPRINKLER
 - RAINBIRD RD1812 POP-UP SPRINKLER
 - ISOLATION VALVE (LINE SIZE)
 - RAINBIRD 44RC QUICK COUPLING VALVE
 - 1" AIR/VACUUM VENT
 - MANUAL DRAIN VALVE
 - SWING CHECK VALVE (LINE SIZE)
 - SPRING CHECK VALVE (LINE SIZE)
 - CLASS 200 PVC SLEEVE (MIN. 4" DIA.)
 - EXISTING 6" DIA. SCH. 40 PVC SLEEVE

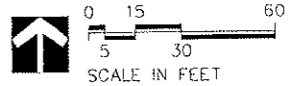

ORIGINAL

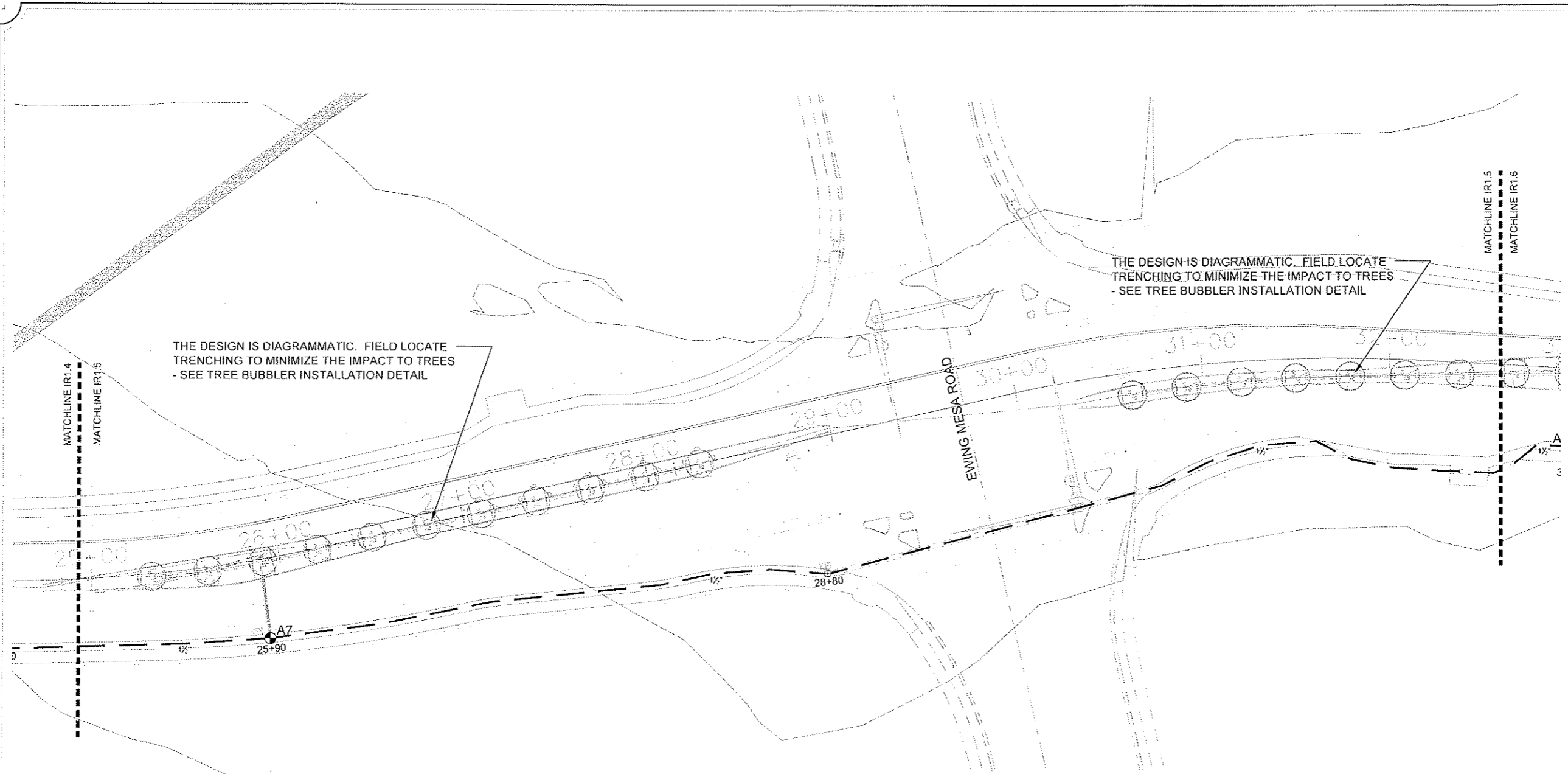

SPRINKLER TYPE BY ZONE			
ZONE	SPRINKLER	VALVE	GPM
A1	RD1812-S-P45-F w/ Hunter MP2000	1"	22
A2	RD1812-S-P45-F w/ Hunter MP2000	1"	21
A3	1402 HCV	1"	23
A4	1401 HCV	1"	23
A5	1402 HCV	1"	17
A6	1402 HCV	1"	17
A7	1402 HCV	1"	11
A8	1402 HCV	1"	11
B1	1402 HCV	1"	20
B2	1402 HCV	1"	20
B3	1402 HCV	1"	14
B4	1401 HCV	1"	10
B5	1402 HCV	1"	11
B6	1402 HCV	1"	13

- KEY:
- RAINBIRD LDI TWO-WIRE DECODER INTERFACE
 - BACKFLOW PREVENTER ENCLOSURE
 - 1 1/2" DIA. SCH. 40 PVC MAINLINE
 - SCH. 40 PVC LATERAL LINE (MIN. 1" DIA.)
 - RAINBIRD MAXI-CABLE
 - RAINBIRD LSP-1 LINE SURGE PROTECTION
 - RAINBIRD PEB ZONE VALVE
 - RAINBIRD 1400 BUBBLER SPRINKLER
 - RAINBIRD RD1812 POP-UP SPRINKLER
 - ISOLATION VALVE (LINE SIZE)
 - RAINBIRD 44RC QUICK COUPLING VALVE
 - 1" AIR/VACUUM VENT
 - MANUAL DRAIN VALVE
 - SWING CHECK VALVE (LINE SIZE)
 - SPRING CHECK VALVE (LINE SIZE)
 - CLASS 200 PVC SLEEVE (MIN. 4" DIA.)
 - EXISTING 6" DIA. SCH. 40 PVC SLEEVE

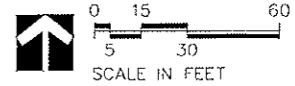

GOFF
ENGINEERING & SURVEYING, INC.
GOFF ENGINEERING & SURVEYING, INC.
126 ROCK POINT DRIVE SUITE A
P.O. BOX 97
DURANGO, COLORADO 81302
(970) 247-1705
www.GoffEngineering.com



Goff Engineering & Surveying, Inc. expressly reserves the common law copyright and other property rights in these plans. These plans are not to be changed or copied in any form or manner whatsoever nor are they to be assigned to any third party without first obtaining written permission and consent of Goff Engineering & Surveying, Inc. ©

**US 160 / WILSON GULCH
ROADWAY EXTENSION**
CITY OF DURANGO, COLORADO
PROJECT STA-M350-022- SA# 19902

Issue Record
100% CONSTRUCTION DOCUMENTS
MARCH 31, 2012

Revisions:

Project Number: 11-0-18
Drawn By: DM
Designed by: DM
Checked By:
Sheet

IR 1.5
IRRIGATION PLAN



LANDSCAPE ARCHITECTURE
LICENSED PROFESSIONAL
LANDSCAPE ARCHITECT
1508 East Oak Ave. Room 23
Durango, CO 81302 | P: 970.247.1705

Goff Engineering & Surveying, Inc. expressly reserves the common law copyright and other property rights in these plans. These plans are not to be changed or copied in any form or manner whatsoever nor are they to be assigned to any third party without first obtaining written permission and consent of Goff Engineering & Surveying, Inc. ©

**US 160 / WILSON GULCH
ROADWAY EXTENSION**
CITY OF DURANGO, COLORADO
PROJECT STA-M350-022- SA# 19902

ORIGINAL

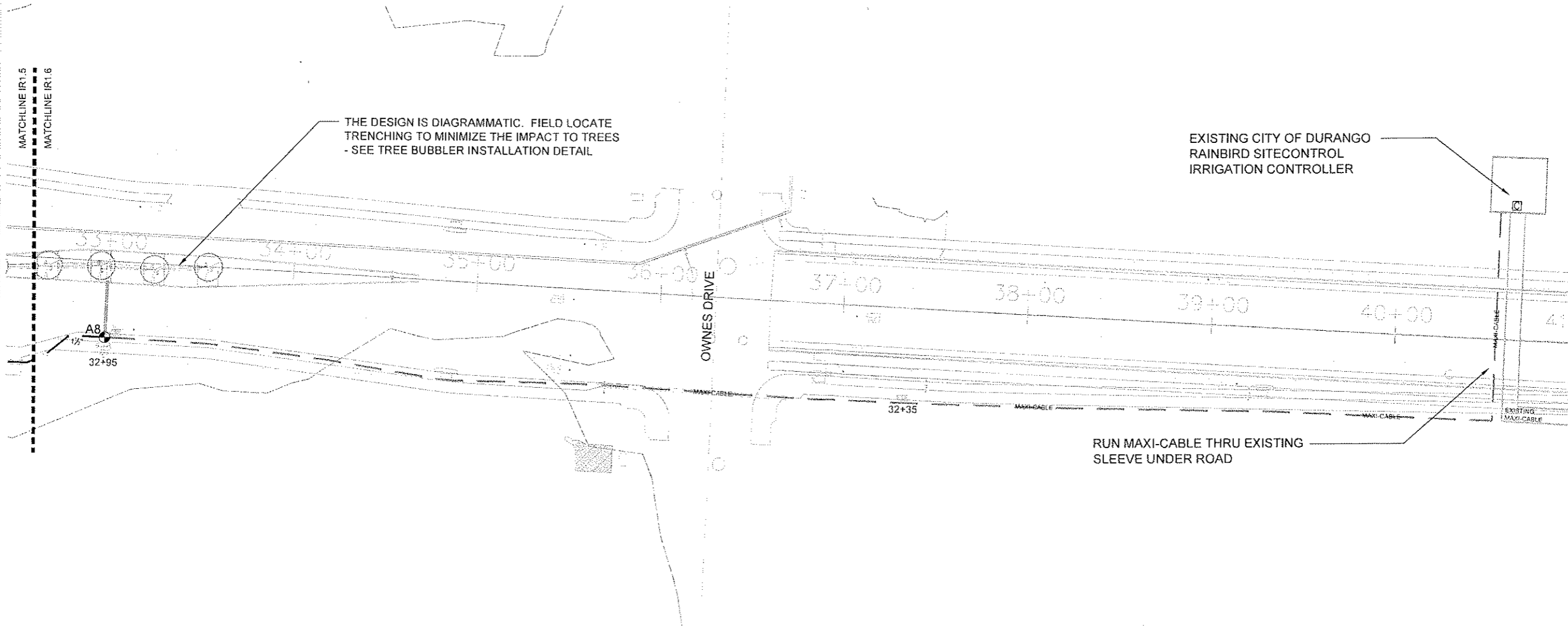

SPRINKLER TYPE BY ZONE			
ZONE	SPRINKLER	VALVE	GPM
A1	RD1812-S-P45-F w/ Hunter MP2000	1"	22
A2	RD1812-S-P45-F w/ Hunter MP2000	1"	21
A3	1402 HCV	1"	23
A4	1401 HCV	1"	23
A5	1402 HCV	1"	17
A6	1402 HCV	1"	17
A7	1402 HCV	1"	11
A8	1402 HCV	1"	11
B1	1402 HCV	1"	20
B2	1402 HCV	1"	20
B3	1402 HCV	1"	14
B4	1401 HCV	1"	10
B5	1402 HCV	1"	11
B6	1402 HCV	1"	13

- KEY:
- ☐ RAINBIRD LDI TWO-WIRE DECODER INTERFACE
 - ☐ BACKFLOW PREVENTER ENCLOSURE
 - 1 1/2" DIA. SCH. 40 PVC MAINLINE
 - SCH. 40 PVC LATERAL LINE (MIN. 1" DIA.)
 - RAINBIRD MAXI-CABLE
 - ☐ RAINBIRD LSP-1 LINE SURGE PROTECTION
 - ☐ RAINBIRD PEB ZONE VALVE
 - ☐ RAINBIRD 1400 BUBBLER SPRINKLER
 - RAINBIRD RD1812 POP-UP SPRINKLER
 - ⊕ ISOLATION VALVE (LINE SIZE)
 - ☐ RAINBIRD 44RC QUICK COUPLING VALVE
 - ☐ 1" AIR/VACUUM VENT
 - ☐ MANUAL DRAIN VALVE
 - ☐ SWING CHECK VALVE (LINE SIZE)
 - ☐ SPRING CHECK VALVE (LINE SIZE)
 - ☐ CLASS 200 PVC SLEEVE (MIN. 4" DIA.)
 - ☐ EXISTING 6" DIA. SCH. 40 PVC SLEEVE

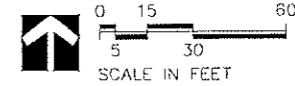

Issue Record:
100% CONSTRUCTION DOCUMENTS
MARCH 11, 2016

Revisions:

Project Number: 11-048

Drawn By: DM

Designed by: DM

Checked By:

Sheet

IR 1.6

IRRIGATION PLAN

ORIGINAL

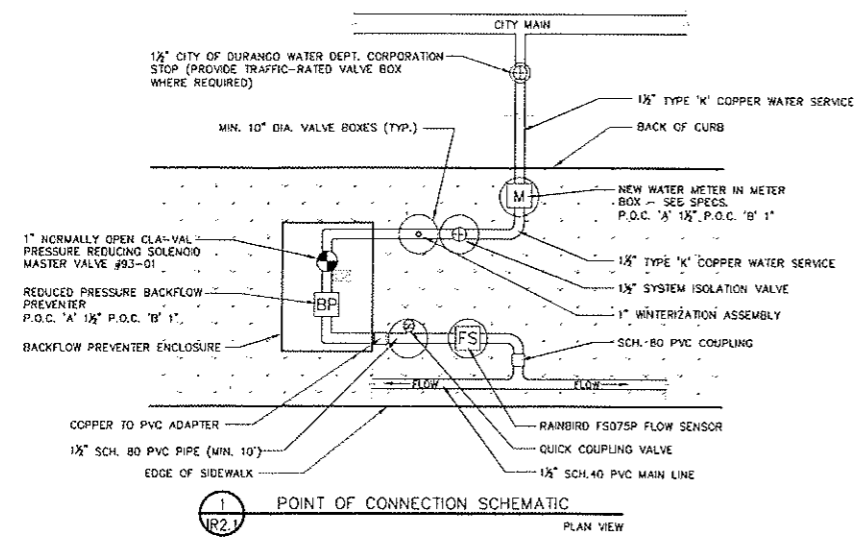

1
IR2.1
POINT OF CONNECTION SCHEMATIC
PLAN VIEW
N.T.S.

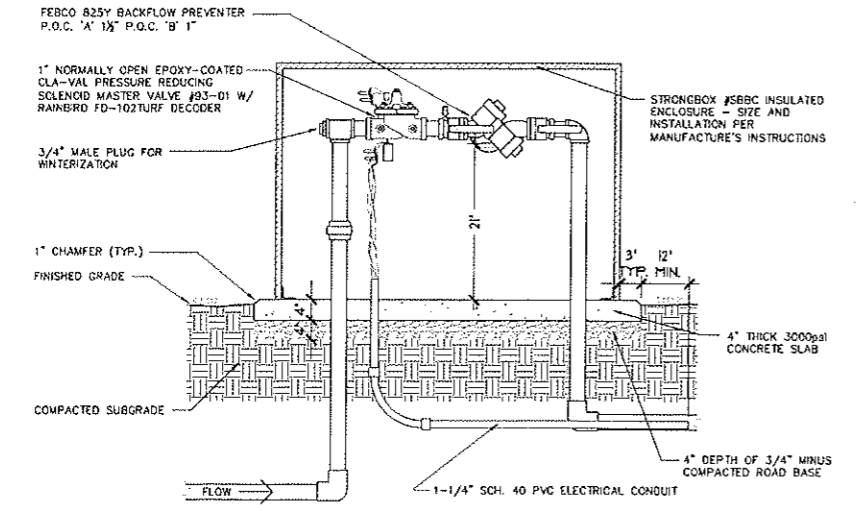

4
IR2.1
FEBCO 825Y REDUCED PRESSURE BACKFLOW PREVENTER
INSTALLATION DETAIL
N.T.S.

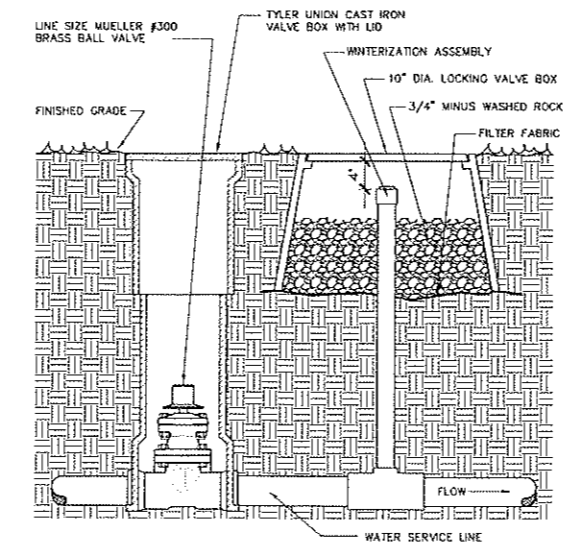

2
IR2.1
SYSTEM ISOLATION VALVE DETAIL
N.T.S.

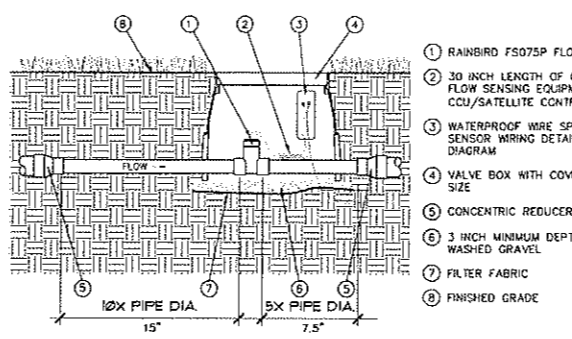

5A
IR2.1
FLOW SENSOR
INSTALLATION DETAIL
N.T.S.

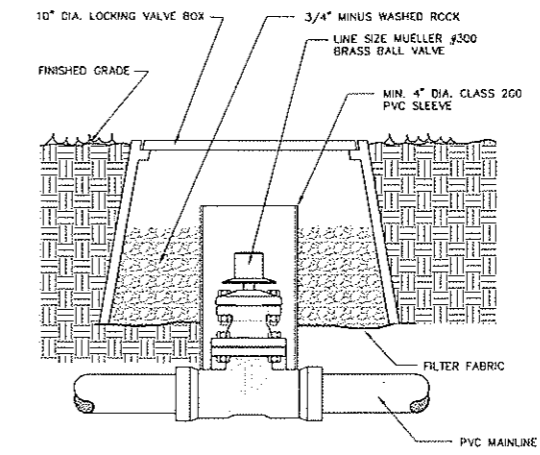

3
IR2.1
ISOLATION VALVE DETAIL
N.T.S.

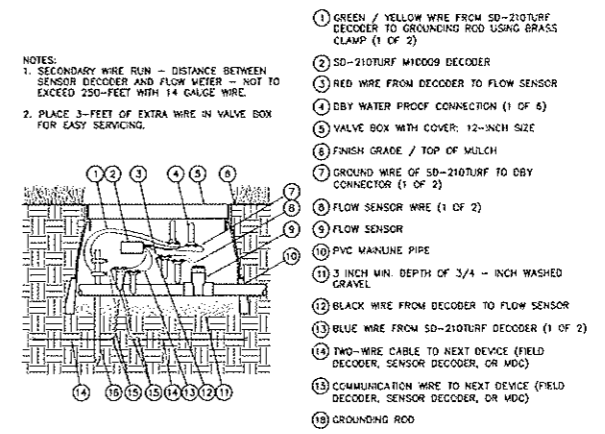

5B
IR2.1
TWO-WIRE FLOW SENSOR DECODER WIRING
N.T.S.

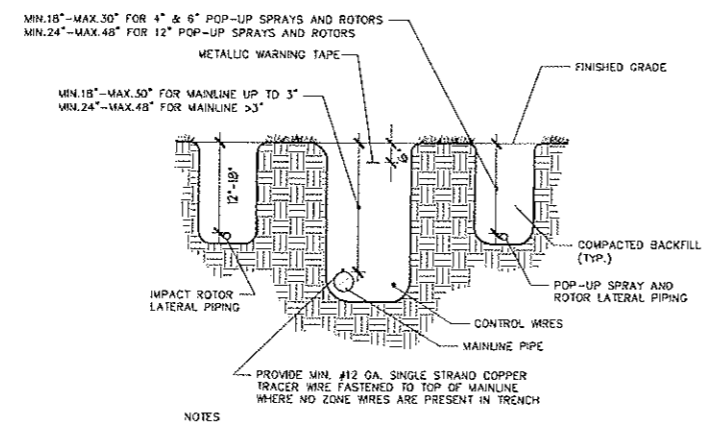

6
IR2.1
STANDARD IRRIGATION TRENCH DETAIL
N.T.S.

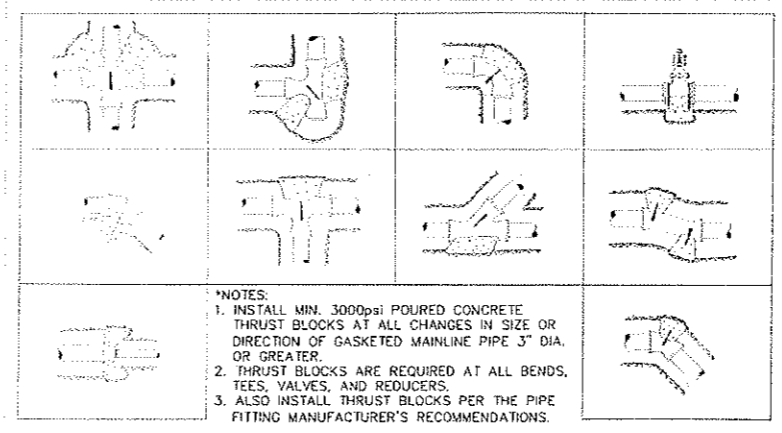

7
IR2.1
TYPICAL THRUST BLOCK DETAILS
N.T.S.

GOFF
ENGINEERING & SURVEYING, INC.
GOFF ENGINEERING & SURVEYING, INC.
126 ROCK POINT DRIVE SUITE A
DURANGO, COLORADO 81302
(970) 247-1705
www.GoffEngineering.com



Goff Engineering & Surveying, Inc. expressly reserves the common law copyright and other property rights in these plans. These plans are not to be changed or copied in any form or manner whatsoever nor are they to be assigned to any third party without first obtaining written permission and consent of Goff Engineering & Surveying, Inc. ©

US 160 / WILSON GULCH
ROADWAY EXTENSION
CITY OF DURANGO, COLORADO
PROJECT STA-M350-022: SA# 19902

Issue Record:	
100% CONSTRUCTION DOCUMENTS	
MARCH 31, 2019	
Revisions:	
Project Number:	11-048
Drawn By:	DM
Designed by:	DM
Checked By:	
Sheet	

IR 2.1
IRRIGATION
DETAILS

ORIGINAL

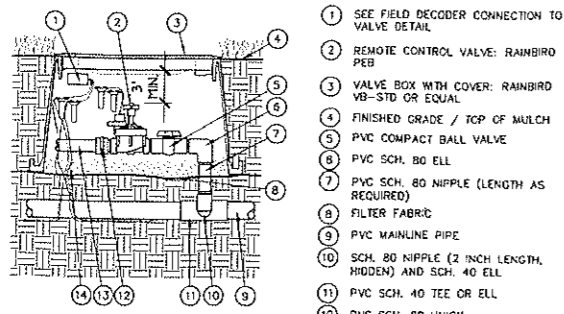

*NOTE: ONLY FD-101TURF DECODERS SHALL BE USED WITH PEB/PESB VALVES

1A RAINBIRD PEB / PESB SERIES IRRIGATION ZONE VALVE N.T.S.

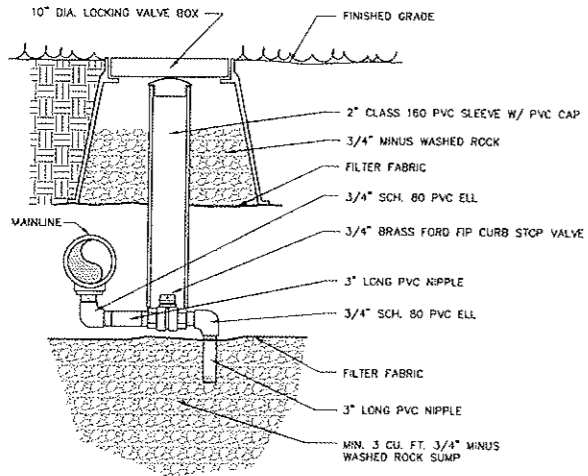

*NOTE: ALL PVC NIPPLES SHALL BE SCHEDULE 80.

3 MANUAL DRAIN VALVE DETAIL N.T.S.

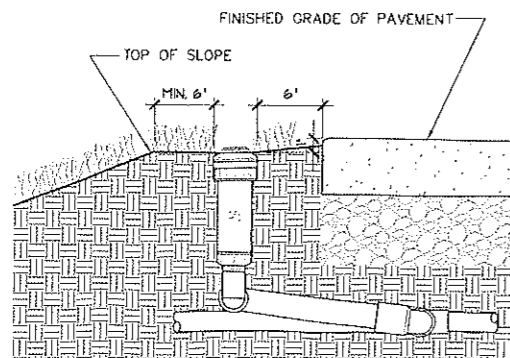

6 TYPICAL SPRINKLER INSTALLATION DETAIL N.T.S.

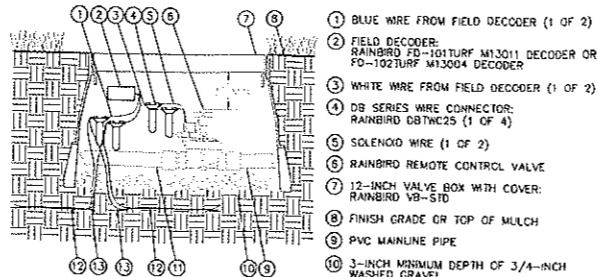

NOTES:
 1. MAXIMUM LENGTH OF SECONDARY WIRE PATH (14 AWG) FROM FIELD DECODER TO SOLENOID IS 450 FEET.
 2. PLACE 3 FEET OF EXTRA WIRE IN EVERY VALVE BOX FOR EASIER SERVICING.
 3. INSTALL ALL NECESSARY EQUIPMENT, INCLUDING SURGE PROTECTION AT MAX. 500' INTERVALS, AS RECOMMENDED BY THE MANUFACTURER.

1B FD-101TURF OR FD-102TURF DECODER CONNECTION TO VALVE N.T.S.

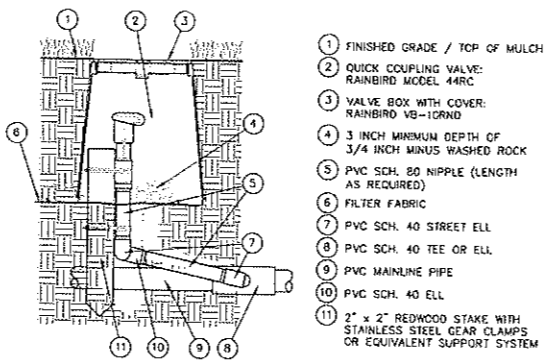

*NOTE: FURNISH FITTINGS AND PIPING NOMINALLY SIZED IDENTICAL TO NOMINAL QUICK COUPLING VALVE INLET SIZE.

4 RAINBIRD 44RC QUICK COUPLING VALVE N.T.S.

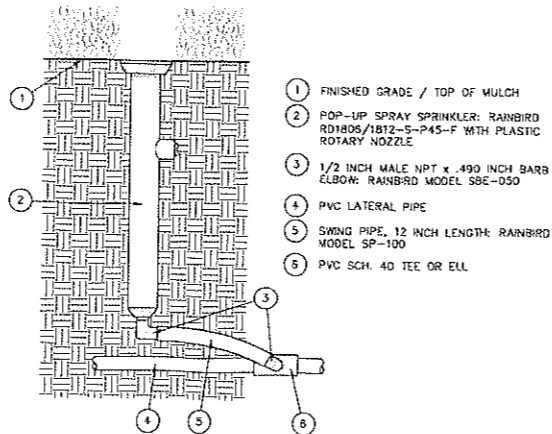

7 RAINBIRD 1806/1812 ROTARY POP-UP SPRINKLER N.T.S.

NOTES:
 1. LSP-1 SHALL BE INSTALLED EVERY 500' ON TWO-WIRE PATH
 2. LSP-1 SHALL BE INSTALLED AT END OF WIRE RUN THAT TERMINATES IN THE FIELD (STAR CONFIGURATION)
 3. LSP-1 MAY ALSO BE INSTALLED WITH VALVES IN VALVE BOXES.

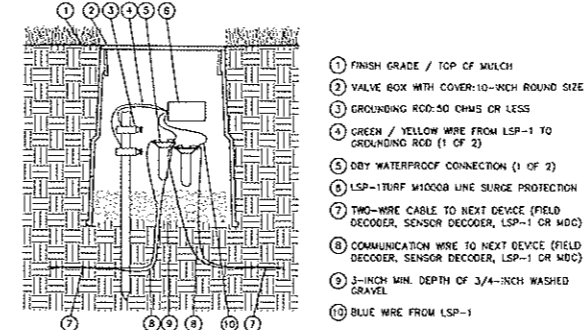

2 TWO-WIRE SURGE PROTECTION N.T.S.

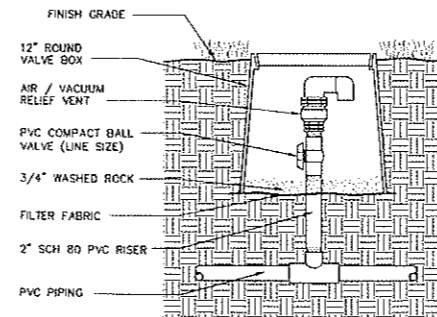

*NOTE: COMBINATION AIR/VACUUM RELIEF VENT SHALL BE 1" NETAFIM NYLON COMBINATION AIR/VACUUM VENT

5 NETAFIM COMBINATION AIR/VACUUM VENT N.T.S.

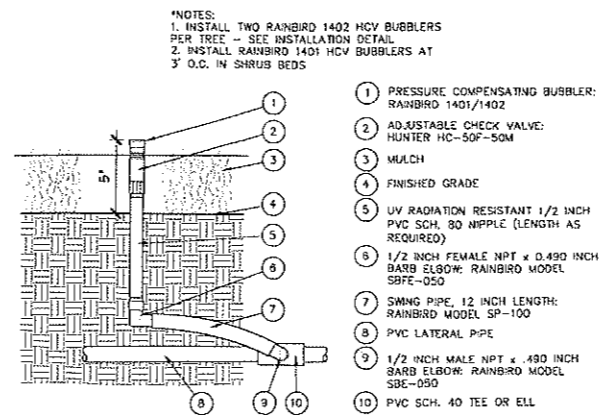

8A RAINBIRD 1400 HCV BUBBLER N.T.S.

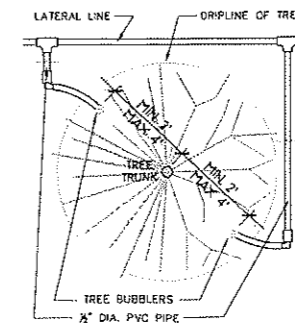

PLAN VIEW

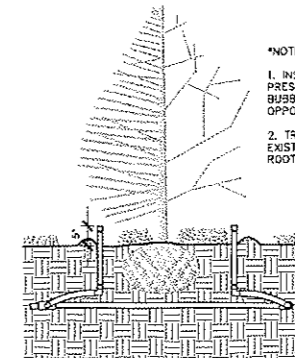

SECTION

8B TREE BUBBLER INSTALLATION DETAIL N.T.S.

GOFF
ENGINEERING & SURVEYING, INC.

GOFF ENGINEERING & SURVEYING, INC.
 126 ROCK POINT DRIVE SUITE A
 P.O. BOX 97
 DURANGO, COLORADO 81302
 (970) 247-1705
 www.GoffEngineering.com



Goff Engineering & Surveying, Inc. expressly reserves the common law copyright and other property rights in these plans. These plans are not to be changed or copied in any form or manner whatsoever nor are they to be assigned to any third party without first obtaining written permission and consent of Goff Engineering & Surveying, Inc. ©

US 160 / WILSON GULCH ROADWAY EXTENSION
 CITY OF DURANGO, COLORADO
 PROJECT STA-M350-022: SA# 19902

Issue Record:
 100% CONSTRUCTION DOCUMENTS
 MARCH 31, 2015

Revisions:

Project Number: 11-048

Drawn By: DM

Designed by: DM

Checked By:

Sheet

IR 2.2

IRRIGATION DETAILS